

POULTRY COOLING SYSTEMS

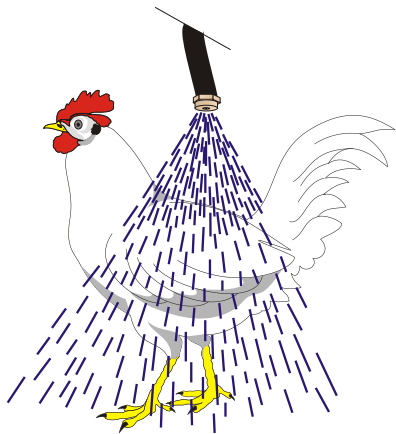

Digitally Controlled Evaporative Cooling Systems

Complete Cooling Systems,
Economical & Reliable Solid State Controllers,
Spray & Fog Nozzles, Manual & Automatic Control

DIGI-COOL[®] Controllers Model DG2100

- Two Stage Temperature settings
- Program Memory saves settings during power outages
- Smart-Scan displays current settings while controller is running
- Optional 24-Hour Real Time Clock
- Optional Sequencing - Up to 4 Control Zones

Sprayers

- 180° or 360° Sprayers
- Various Radii Available
- 6, 9, 12, or 17 GPH

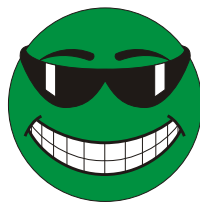

Foggers

- Foggers available in 1/2, 1, and 1 1/2 GPH
- Internal Filter - Helps Prevent Clogging

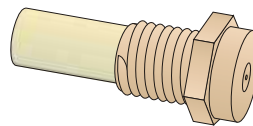
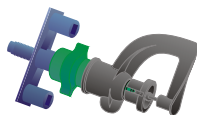
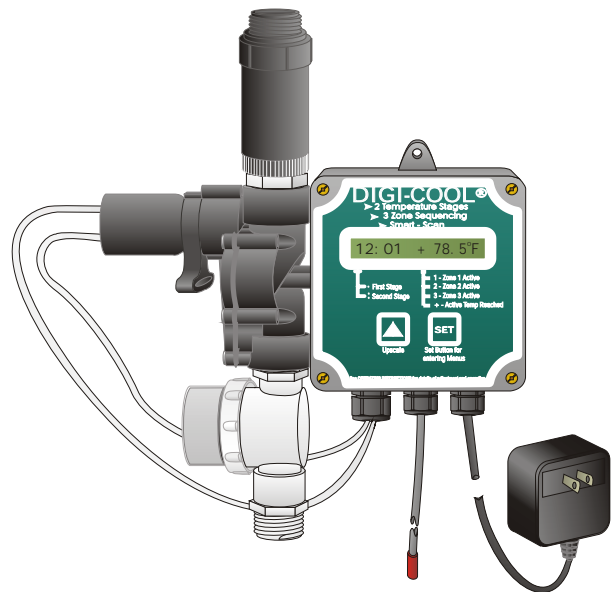

8827 Garden Lane * Greendale, WI 53129

(414) 529-0900

www.greenhillmfg.com

GREENHILL
Manufacturing, Ltd.

Poultry House Fog Nozzle Applications

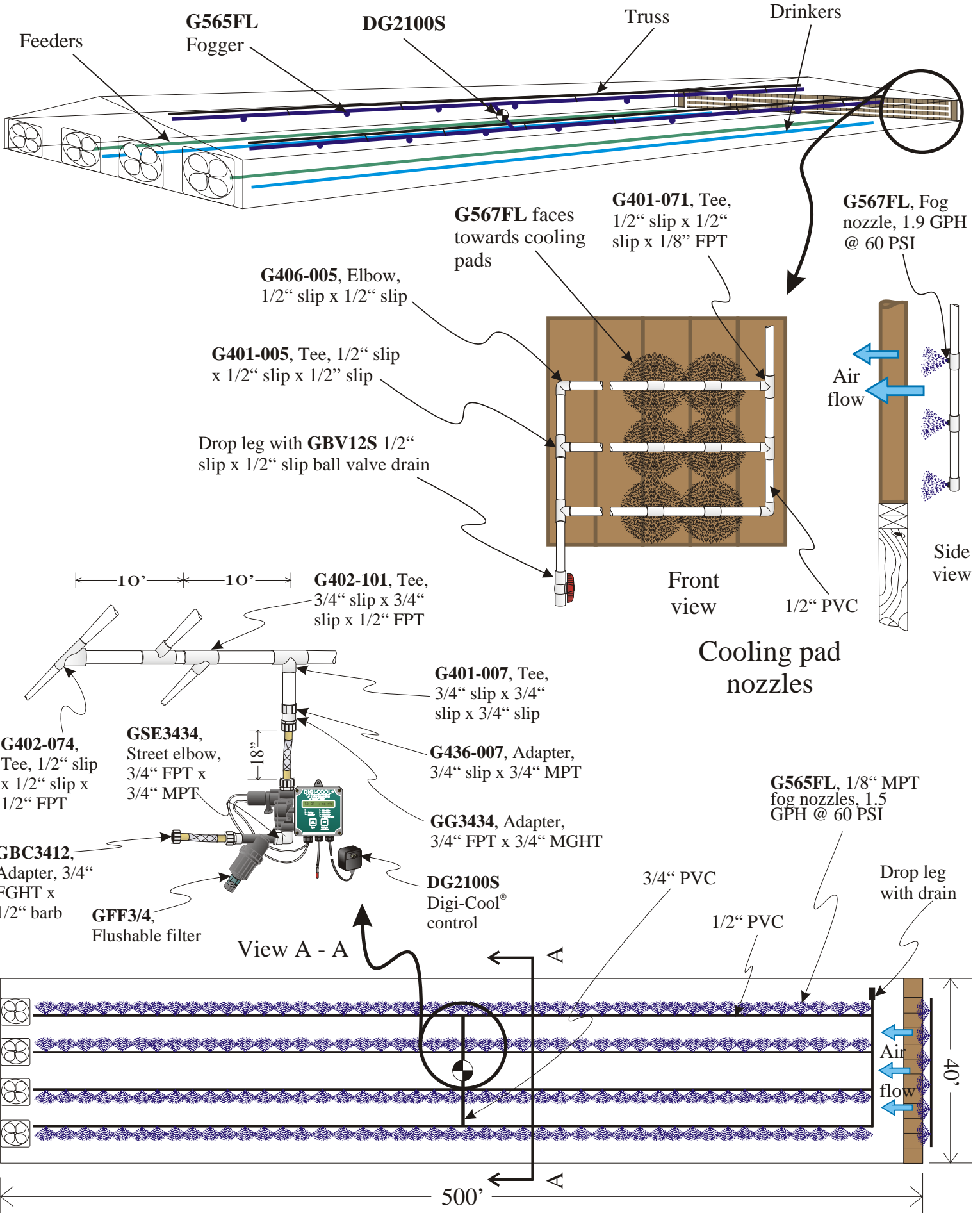

Increase profit!

Poultry Plastic Fog Nozzle Cooling System Update

Inexpensive!

- ❑ Stop buying expensive brass or stainless steel nozzles
- ❑ Non-corroding **low cost** plastic construction
- ❑ Easy installation
- ❑ Significantly lower air temperature
- ❑ Increase feed efficiency and weight gain
- ❑ Decrease respiratory problems and spread of disease
- ❑ Remove dust from air

Decrease dust in the air!

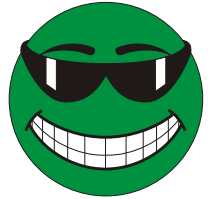

Fogger Chart (High Pressure)



G565FL with foam filter

Fogger	60 PSI	75 PSI	150 PSI	Color	Price
G560FL	1.0 GPH	1.2 GPH	1.5 GPH	Grey	\$1.35
G565FL	1.5 GPH	1.6 GPH	2.2 GPH	Cream	\$1.35
G567FL	1.9 GPH	2.1 GPH	3.1 GPH	Blue	\$1.35

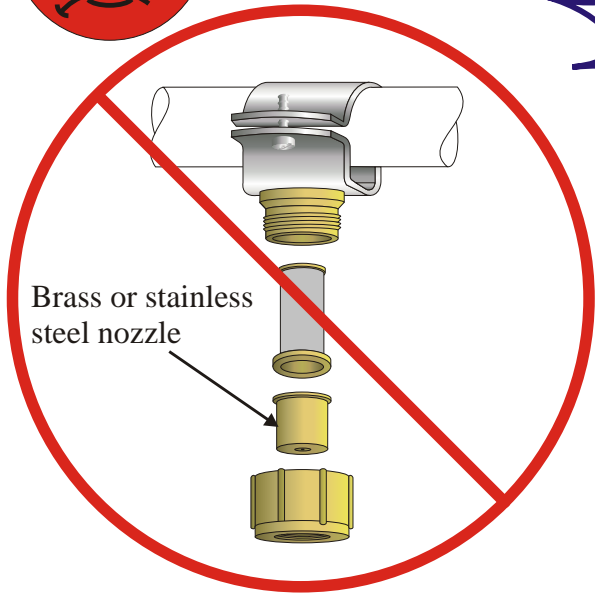

Brass or stainless steel nozzle

Typical old system

Don't use old expensive brass systems!

Greenhill has nozzles for almost any spray or fog system you could need. They can be used for fogging; spraying; cooling people, greenhouses, poultry, cows, sows, and hogs; propagation; dust control; agriculture; fish; and aquaculture. Greenhill nozzles operate efficiently at low pressure and also work well in higher pressure systems.

Decrease heat stress!

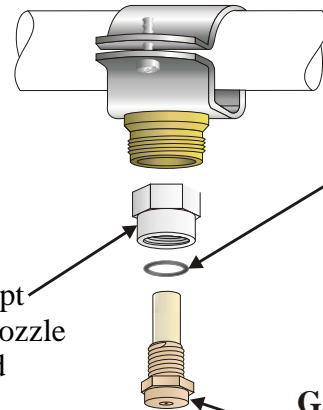

GCR111618, Coupling to adapt 1/8" MPT fog nozzle to 11/16" thread

GORING-01E, O-ring for 1/8" fog nozzles. Seals without the use of tape.

G565FL, Fog nozzle, 1.5 GPH @ 60 PSI

Easy to install!

Use Greenhill's **inexpensive** plastic fog nozzle assembly!

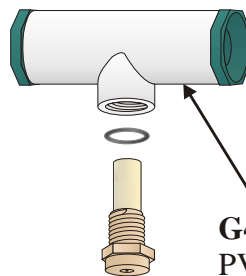

G402-071C, PVC tee, 1/2" comp x 1/2" comp x 1/8" FPT

G402-071, PVC tee, 1/2" slip x 1/2" slip x 1/8" FPT

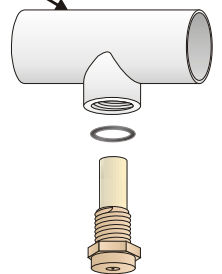

Reduce cost!

Poultry Cleaning System (Pre-Soak) Wire Grate Flooring

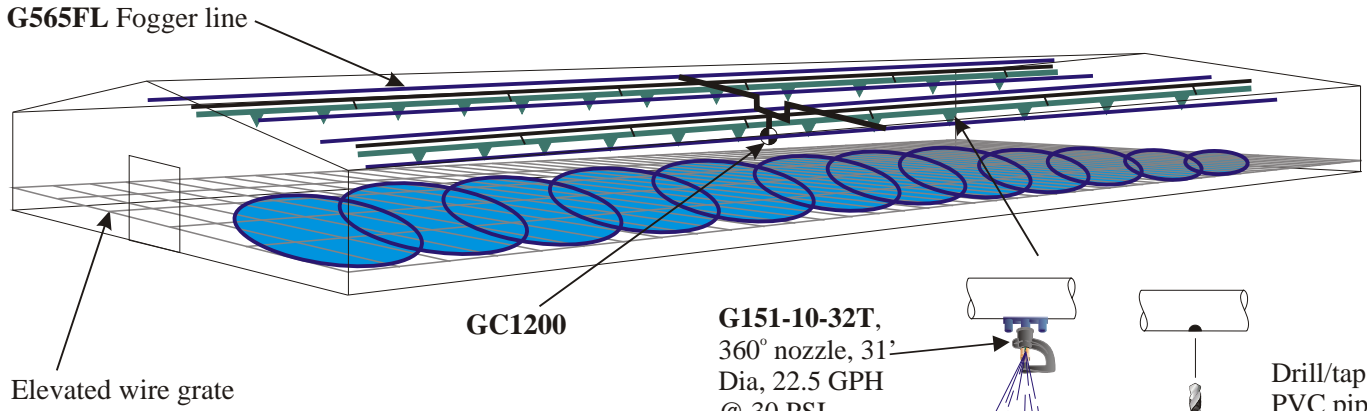

Sprayer Chart (Low Pressure)

Sprayer	10 PSI	15 PSI	20 PSI	Cone	Color
G150-10-32T	7.5 GPH	9.0 GPH	9.8 GPH	360° Full circle	Black rotor
	7.0' dia.	8.0' dia.	9.0' dia.		Orange rotor
G151-10-32T	17.5 GPH	19.5 GPH	22.5 GPH	180°	Black
	17' dia.	21' dia.	25' dia.		Green
G140	9.5 GPH	12 GPH	14 GPH	Half circle	Brown
G143	14 GPH	17 GPH	20 GPH		
G145	4.9 GPH	6.0 GPH	7.5 GPH		

(G140, G143, and G145 have a 3' fixed radius.)

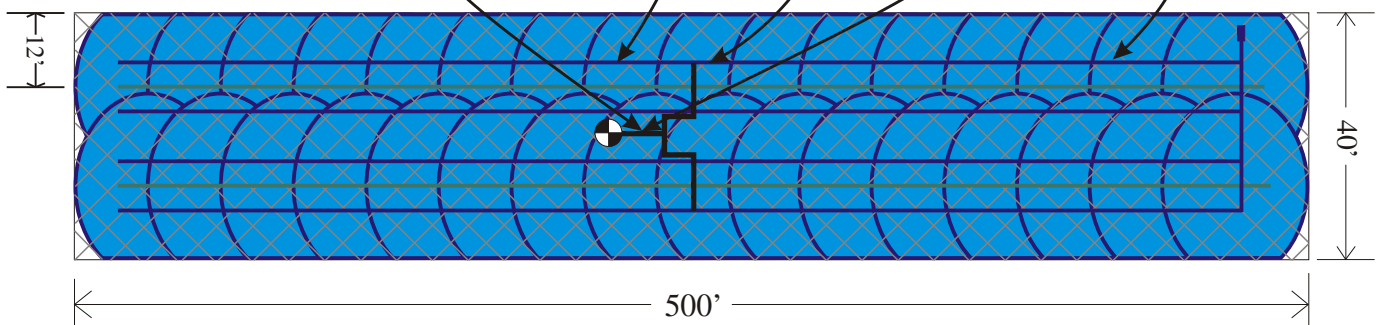
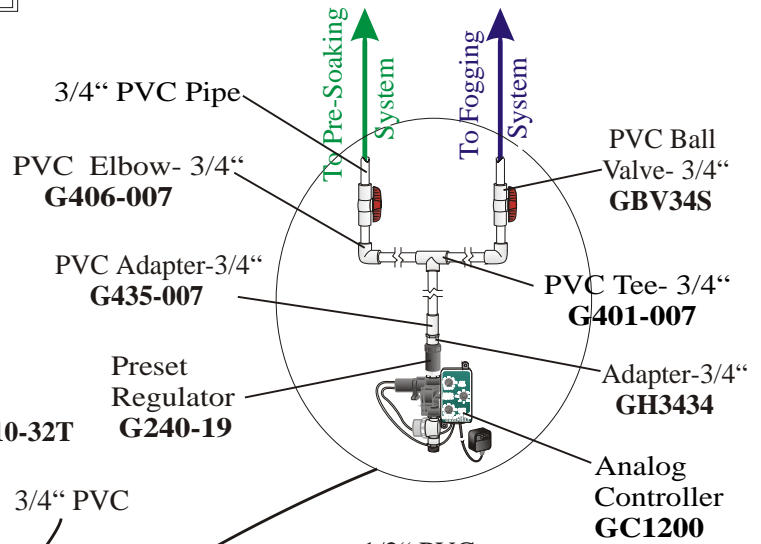
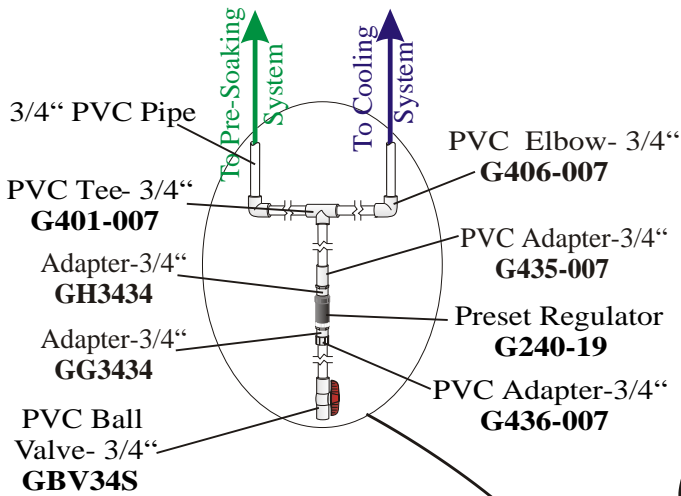
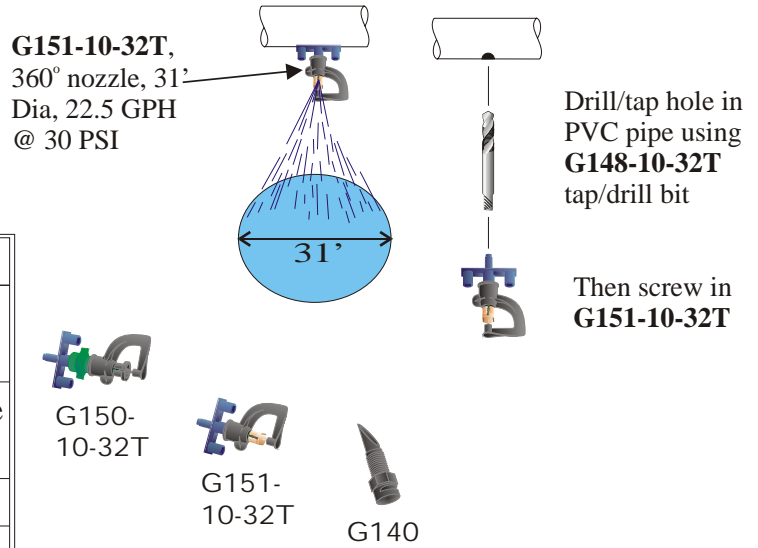

Hole Punch

Place **G280** hole punch perpendicular to 1/2" hose as shown in Figure 1. Using a twisting motion, (Figure 2) cut out a disk from the hose. Figure 3 shows how it should look after the hole has been punched. After all holes are punched and sprayers, foggers, connectors, and tees are attached, flush out the system so that any foreign material that may have entered the lines will be removed and will not clog the sprayers or foggers.

Important!

1. Use only the hole punch supplied to make holes. Use of other objects to make holes may create an uneven, ragged hole which will not seal around barb, resulting in leakage.
2. Replace hole punch when it becomes dull. Attempts to re-sharpen an old punch will change the size of the hole it cuts, and may cause leakage.

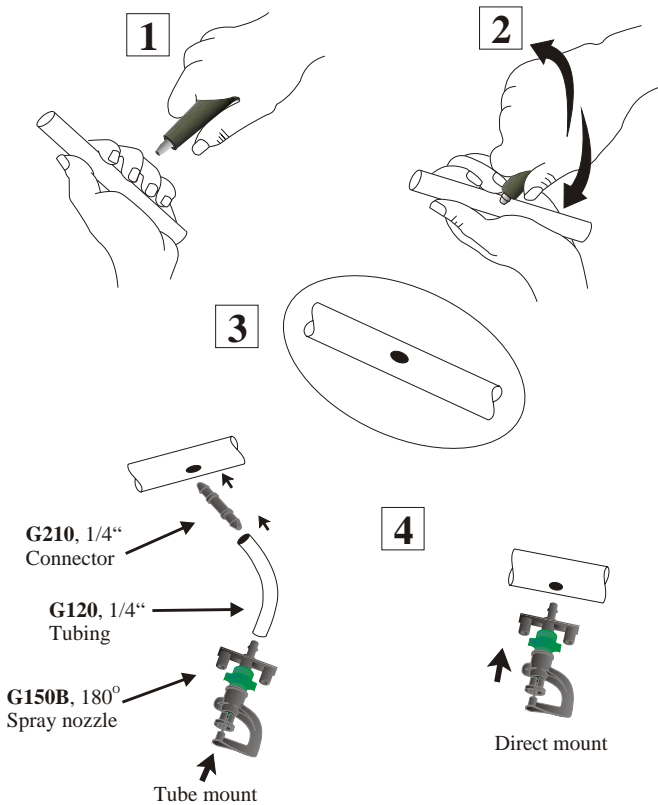

Closing Off Hose Ends

Slide close-off over hose end.

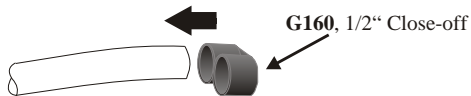

Slide close-off back 6".

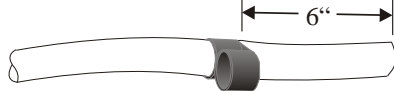

Now fold hose tightly back and kink hose.

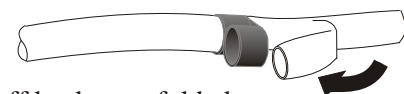

Slide close-off back over folded end.



PVC Econo System (10-32 thread)

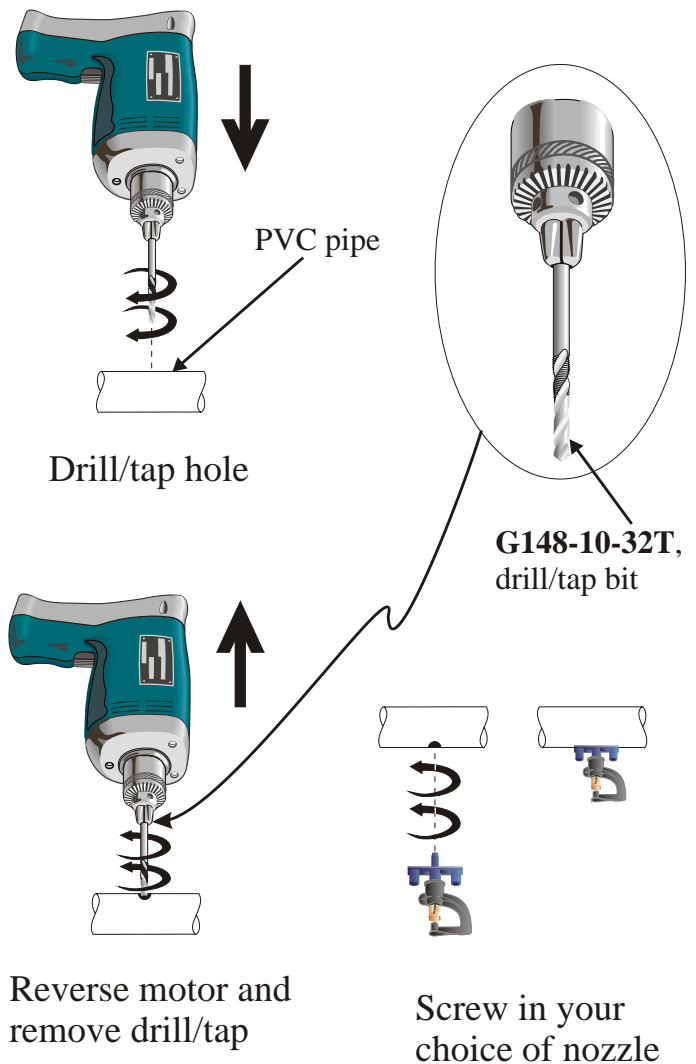

Inserting Fittings (60 PSI)

Cut hose or hoses to desired length, making sure that ends are clean and straight. Push ends into compression fittings, as shown for each one.

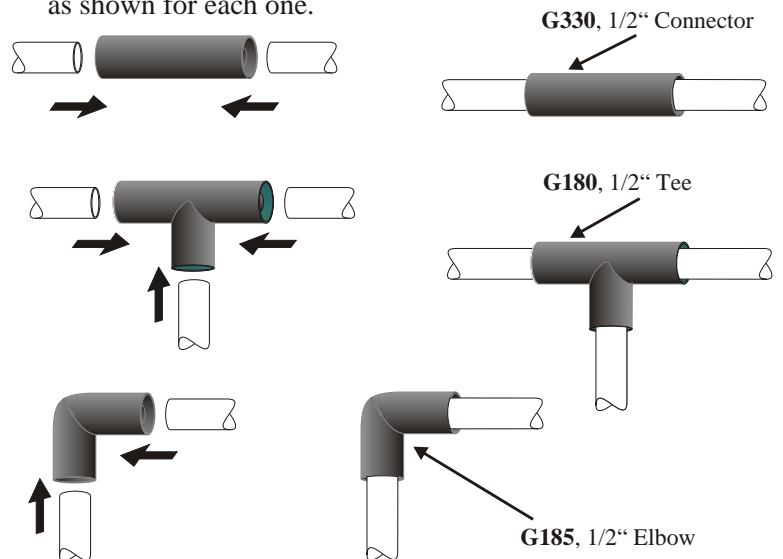



8827 Garden Lane
Greendale, WI 53129
(414) 529-0900